

HOW TO INSTALL YOUR NEW U.S. FLAG SET

Step 1. Place holder on window sill, side of house, porch rail, post, etc. Fasten with three enclosed screws.

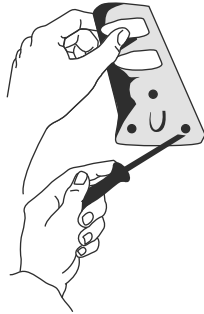

Step 2. Assemble flagpole by inserting tapered sections into non-tapered sections. Insert eagle ornament into top of assembled pole.

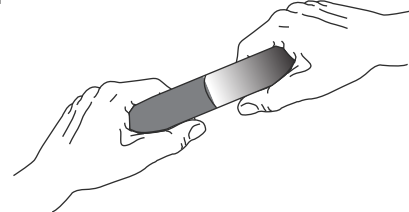

Step 3. Remove set-screw from fastener and slide fastener up pole to just below the ornament.

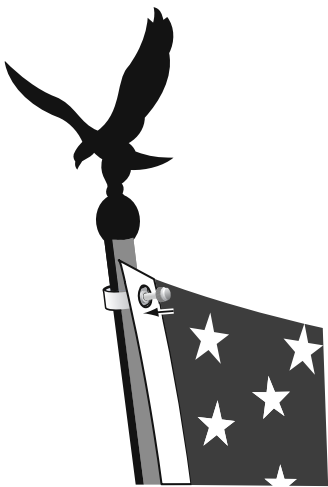
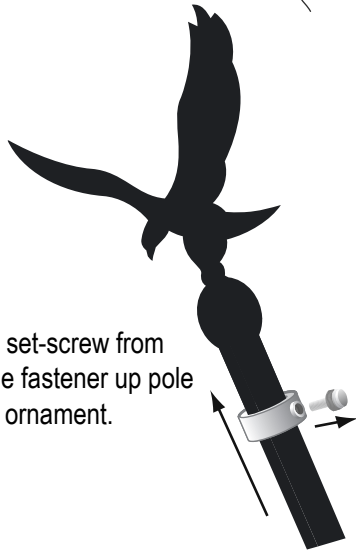

Step 4. Position opening in fastener under the top grommet of the flag.

Step 5. Replace set-screw in fastener through the grommet of the flag, thereby holding flag snug against the pole.

Step 6. Repeat procedure for bottom grommet.

Note: Be careful not to overtighten fastener.

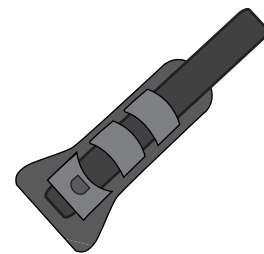

Step 7. Insert pole into bracket.

Note: Remember to take flag down at sunset and do not fly flag in rain or snow.

Care Instructions: Machine wash flag in cold water. Lay flat or hang to dry. Do Not fold while wet.